







NOTES

- GENERAL
- 1) THESE DRAWINGS TO BE READ IN CONJUNCTION WITH ALL RELEVANT HAYES HIGGINS ENGINEERING DRAWINGS AND SPECIFICATIONS.
 - 2) DO NOT SCALE. USE FIGURED DIMENSIONS ONLY.

DRAINAGE LEGEND

-  EXISTING POOL WATER SEWER
-  EXISTING SURFACE WATER SEWER
-  EXISTING WATERMAIN

LEGEND

-  EXTENT OF POROUS ASPHALT SURFACE WATER STORAGE
-  RO RETENTION LANDSCAPED AREAS & TREE PIT
-  POOLING SLAG TO HAVE SLOT DRAINS & STONE BUILD-UP AS SURFACE WATER STORAGE

AREA	STORAGE VOLUME	STONE DEPTH
APARTMENT A,B,C,D ROOF	1,933 m ³	461 mm
ENTRANCE ROAD	393 m ³	13 mm
CAR PARK	668 m ³	27 m ³
TOTAL	107 m ³	650 mm

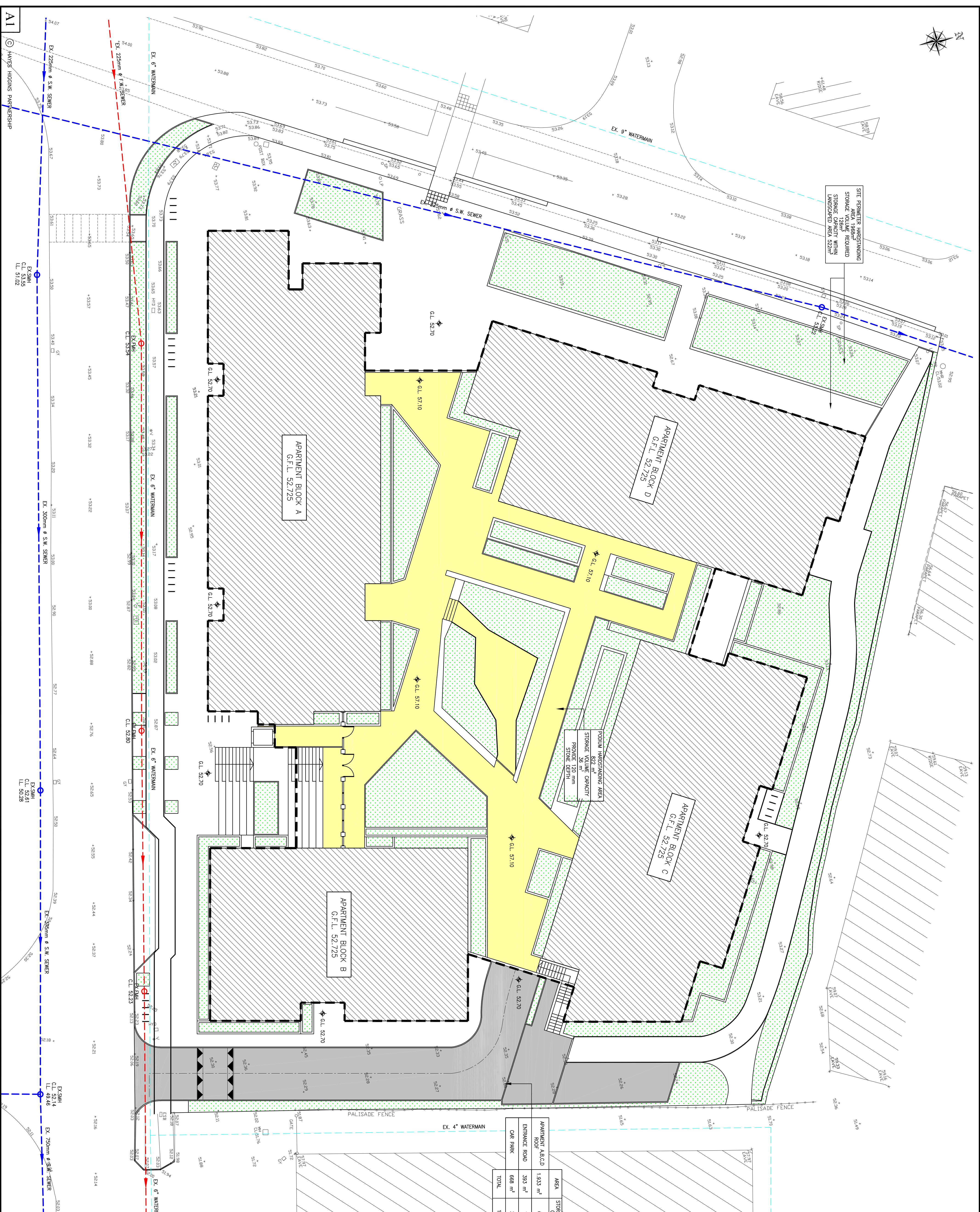

P	ISSUED FOR PLANNING	IS	UA
REV	DATE	DESCRIPTION	DRAWN BY / APPR. BY
PLANNING			
CLIENT: AAI PALMERSTOWN LIMITED			
PROJECT NAME: APARTMENTS AT LINNIES 64 & 65 CHERRY ORCHARD INDUSTRIAL ESTATE			
DRAWING NAME: PROPOSED SUDS LAYOUT			
PROJECT NO.: 20D018			
DRAWING NO.: 07		REVISION: P	
SCALE: 1:200		DRAWN DATE: 22.04.20	
QAD DRAWN BY: F.S.	CHECKED BY: L.M.	APPROVED BY: R.L.	

HAYES HIGGINS PARTNERSHIP

The Glass House, 11 Coke Lane
Smithfield, Dublin 7. Tel: 01 661 2321
E-mail: admin@hayeshiggins.ie
One Hooley Lane, Kildenny, Tel: (086) 7764710
Email: info@hh.ie